

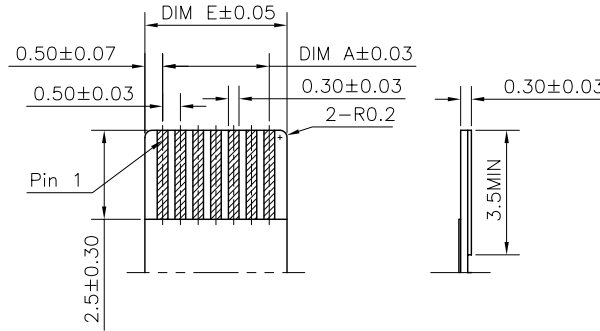

A B C D E F

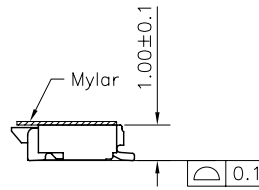

RECOMMENDED FPC/FFC DIMENSIONS  
GENERAL TOLERANCE ±0.05

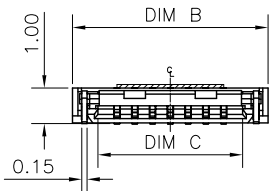
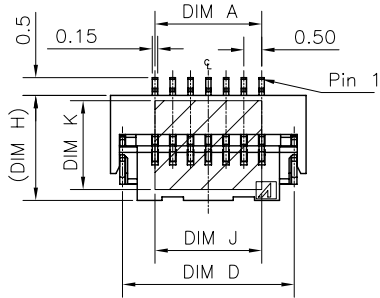
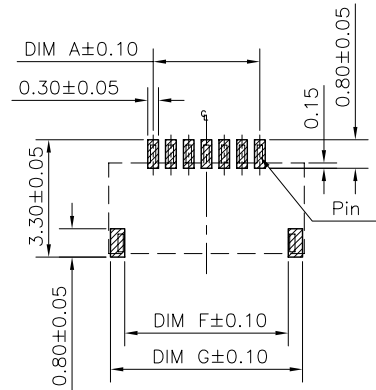

RECOMMENDED PCB LAYOUT  
GENERAL TOLERANCE ±0.05

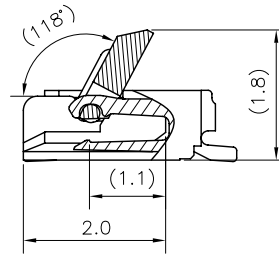

ACTUATOR OPEN STATE  
(SCALE 6:1)

NOTES:

1. MATERIAL:
  - 1.1 HOUSING: THERMOPLASTIC, HIGH TEMP., UL94V-0; COLOR:BLACK.
  - 1.2 ACTUATOR: THERMOPLASTIC, HIGH TEMP., UL94V-0; COLOR:NATURAL.
  - 1.3 CONTACT: COPPER ALLOY
  - 1.4 FITTING NAIL: COPPER ALLOY
2. FINISH:
  - 2.1 CONTACT:
    - 50~100u" NICKEL UNDERPLATING OVERALL.
    - 1:GOLD FLASH PLATING.
    - B:5u" GOLD PLATING ON CONTACT AREA; GOLD FLASH PLATING ON SOLDER AREA
    - D:30u" GOLD PLATING ON CONTACT AREA; GOLD FLASH PLATING ON SOLDER AREA
    - 80~150u" MATT TIN PLATING (LEAD FREE).
    - N:50~100u" NICKEL UNDERPLATING OVERALL.
  - 2.2 FITTING NAIL:
    - 80~120u" MATT TIN PLATING (LEAD FREE).
    - 50~100u" NICKEL UNDERPLATING OVERALL.
3. REFLOW SOLDER CAPABLE TO 260°C PER ACES SPEC.
4. SPEC. PLS. REFER TO PS-51614-xxxx-xxx
5. PACKAGE PLS REFER TO PS-91506-xxxx-TRP
6. PART NUMBER

51614-XXX X X-XXX	XXX	HOUSING COLOR	ACTUATOR COLOR	PACKING
	002	BLACK	NATURAL	91506-XXXX-TRP

NO OF CKT

PACKING  
0: TAPE & REEL  
4: TAPE & REEL WITH MYLAR

PLATING  
1: GOLD FLASH  
N: MATT TIN  
B: 5u" GOLD PLATING ON CONTACT AREA  
GOLD FLASH PLATING ON SOLDER AREA  
D: 30u" GOLD PLATING ON CONTACT AREA  
GOLD FLASH PLATING ON SOLDER AREA

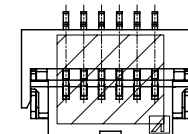

FOR 4~6 CKTS SURFACE

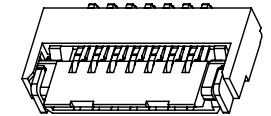

CKT	DIM A	DIM B	DIM C	DIM D	DIM E	DIM F	DIM G	DIM H	DIM J	DIM K
04	1.50	4.0	2.57	3.33	2.50	3.10	3.90	3.0	3.0	2.5
05	2.00	4.5	3.07	3.83	3.00	3.60	4.40			
06	2.50	5.0	3.57	4.33	3.50	4.10	4.90			
07	3.00	5.5	4.07	4.83	4.00	4.60	5.40			
08	3.50	6.0	4.57	5.33	4.50	5.10	5.90			
09	4.00	6.5	5.07	5.83	5.00	5.60	6.40			
10	4.50	7.0	5.57	6.33	5.50	6.10	6.90			
11	5.00	7.5	6.07	6.83	6.00	6.60	7.40			
12	5.50	8.0	6.57	7.33	6.50	7.10	7.90			
13	6.00	8.5	7.07	7.83	7.00	7.60	8.40			
14	6.50	9.0	7.57	8.33	7.50	8.10	8.90			
15	7.00	9.5	8.07	8.83	8.00	8.60	9.40			
16	7.50	10.0	8.57	9.33	8.50	9.10	9.90			
17	8.00	10.5	9.07	9.83	9.00	9.60	10.40			
18	8.50	11.0	9.57	10.33	9.50	10.10	10.90			
19	9.00	11.5	10.07	10.83	10.00	10.60	11.40			
20	9.50	12.0	10.57	11.33	10.50	11.10	11.90			
22	10.50	13.00	11.57	12.33	11.50	12.10	12.90			
24	11.50	14.00	12.57	13.33	12.50	13.10	13.90			
25	12.00	14.50	13.07	13.83	13.00	13.60	14.40			
30	14.50	17.0	15.57	16.33	15.50	16.10	16.90			
40	19.50	22.0	20.57	21.33	20.50	21.10	21.90			

A B C D E F

一般公差 <b>TOLERANCES</b> X ±0.50 XX ±0.15 X ±0.25 XXX ±0.10 ANGLES ±2°		<b>宏致電子股份有限公司</b> <b>Aces Electronics Co.,Ltd.</b>	
檢驗尺寸標示 SYMBOLS  INDICATE CLASSIFICATION MARK IS CRITICAL DIM. MARK IS MAJOR DIM.	品名 (TITLE) 0.5 PITCH FPC EASY ON TYPE H=1.00mm	製圖 (DR) 17/05/19 XUBIN 審核 (CHKD) BRAVE	圖號 (DWG NO.) 51614-XXXX-002 核准 (APPD) FRANK
表面處理 (FINISH)	比例 (SCALE) 3:1	單位 (UNITS) mm	張數 (SHEET) 1 OF 1 圖號 (DWG NO.) 